

This document, together with the concepts and design presented herein, is intended only for the specific purpose and client for which it was prepared. Reuse of and improper reliance on this document without written authorization and adaptation by Kimley-Horn and Associates, Inc. shall be without liability to Kimley-Horn and Associates, Inc.

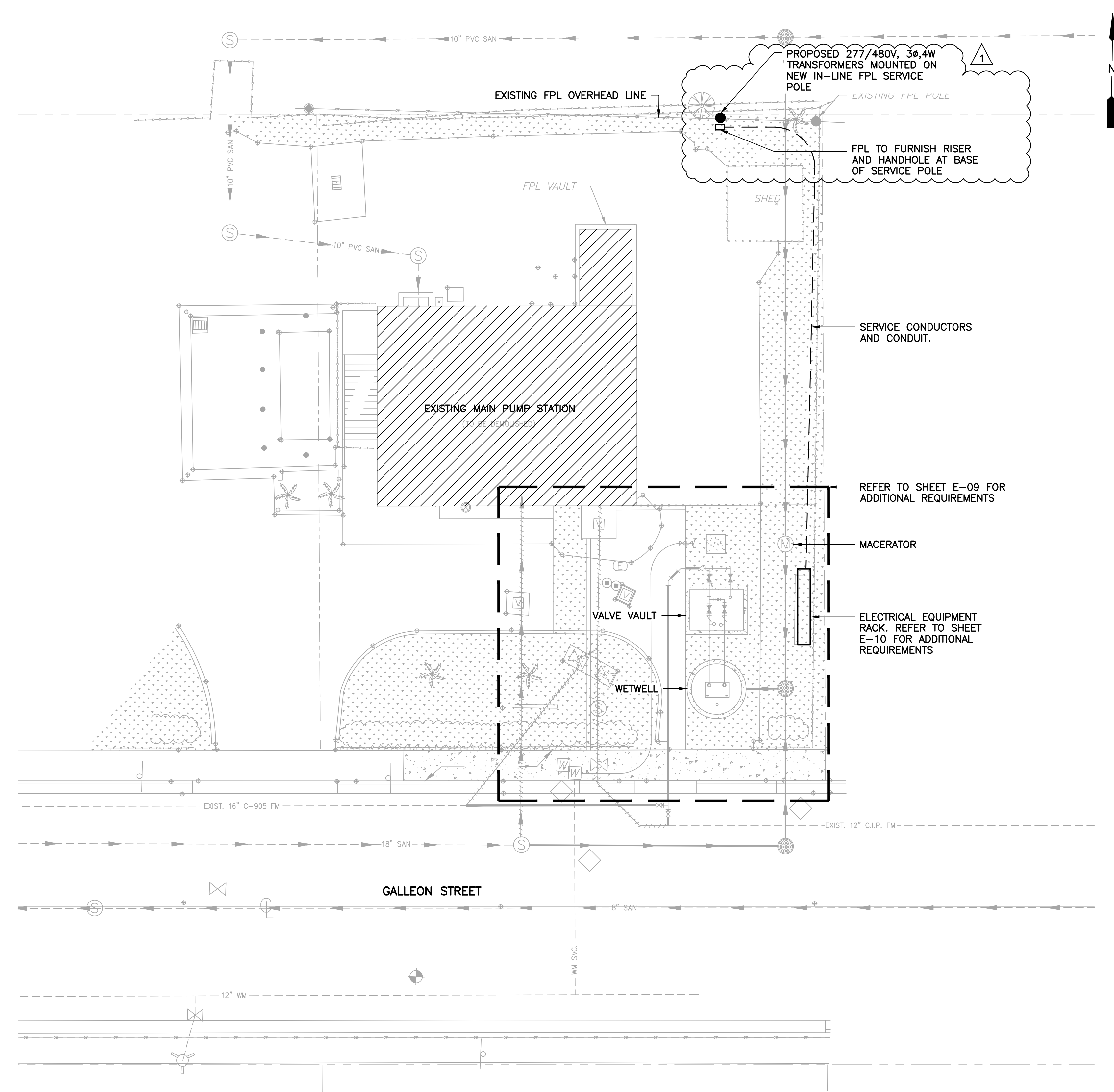

**ELECTRICAL SITE PLAN**  
 SCALE: 1"=10'-0"

**LEGEND:**

**PLAN SYMBOLS**

- ELECTRIC A.C. MOTOR, NO. INDICATES HORSEPOWER.
- CONDUIT RUN EXPOSED. RUN PARALLEL OR PERPENDICULAR TO STRUCTURE OR WALL.
- CONDUIT CONCEALED IN OR BELOW FLOOR OR UNDERGROUND.
- HOME RUN TO PANELBOARD. NUMBER OF ARROWS INDICATE NUMBER OF CIRCUITS. HASH MARKS INDICATE NUMBER OF #12 AWG. CONDUCTORS. NO HASH MARKS INDICATE 2 #12 CONDUCTORS.
- LEVEL TRANSDUCER
- LIQUID LEVEL SWITCH
- TEMPERATURE SWITCH
- SEAL FAIL
- GROUND ROD
- GROUND TEST WELL

**ABBREVIATIONS**

- A AMPERES
- AFG ABOVE FINISHED GRADE
- CP CONTROL PANEL
- CPT CONTROL POWER TRANSFORMER
- FPL FLORIDA POWER & LIGHT
- FVNR FULL VOLTAGE NON-REVERSING
- GND GROUND
- HP HORSEPOWER
- LIT LEVEL INDICATING TRANSMITTER
- MIN MINIMUM
- MSC MANUFACTURER SUPPLIED CABLE
- MTD MOUNTED
- N NEUTRAL
- NEC NATIONAL ELECTRICAL CODE
- NO NUMBER
- NTS NOT TO SCALE
- P POLE
- PSCP PUMP STATION CONTROL PANEL
- SPD SURGE PROTECTION DEVICE
- SS STAINLESS STEEL
- SSS SOLID STATE STARTER
- TYP TYPICAL
- V VOLTS
- VA VOLT AMPERES
- VFD VARIABLE FREQUENCY DRIVE
- W WIRE
- WP WEATHERPROOF
- w/ WITH
- φ PHASE

**NOTES**

1. ELECTRICAL CONTRACTOR SHALL SUPPLY AND INSTALL ALL NEW ELECTRICAL WORK INDICATED.
2. ELECTRICAL CONTRACTOR SHALL VISIT JOB SITE AND FAMILIARIZE HIMSELF WITH ALL CONDITIONS AFFECTING ELECTRICAL INSTALLATION AND MAKE PROVISIONS AS TO THE COST THEREOF. EXISTING CONDITIONS OF ELECTRICAL EQUIPMENT, LIGHT FIXTURES, ETC... THAT ARE PART OF THE FINAL SYSTEM SHALL BE VERIFIED BY THE CONTRACTOR PRIOR TO SUBMITTING HIS BID.
3. ALL WORK SHALL BE DONE IN ACCORDANCE WITH THE 2014 NATIONAL ELECTRICAL CODE, 2020 FLORIDA BUILDING, 2020 NATIONAL FIRE PROTECTION ASSOCIATION, AND SHALL COMPLY WITH ALL LOCAL RULES AND ORDINANCES.
4. MINIMUM WIRE SIZE SHALL BE #12 A.W.G. FOR POWER CIRCUITS.
5. IT IS NOT THE INTENT OF THESE PLANS TO SHOW EVERY MINOR DETAIL OF CONSTRUCTION. THE CONTRACTOR IS EXPECTED TO FURNISH AND INSTALL ALL ITEMS FOR A COMPLETE ELECTRICAL SYSTEM AND PROVIDE ALL REQUIREMENTS NECESSARY FOR THE EQUIPMENT TO BE PLACED IN PROPER WORKING ORDER.
6. ELECTRICAL SYSTEM SHALL BE COMPLETE AND EFFECTIVELY GROUNDED AS REQUIRED BY THE LATEST EDITION OF THE N.E.C. OR LOCAL CODES. ALL CONDUITS SHALL HAVE A BOND WIRE SIZED PER TABLE 250-122 OF THE NATIONAL ELECTRICAL CODE.
7. ALL MATERIALS SHALL BE NEW AND BEAR UNDERWRITERS' LABELS WHERE APPLICABLE.
8. ALL WORK SHALL BE PERFORMED BY A LICENSED ELECTRICAL CONTRACTOR IN A FIRST CLASS WORKMANLIKE MANNER. THE COMPLETED SYSTEM SHALL BE FULLY OPERATIVE AND ACCEPTED BY ENGINEER/OWNER.
9. CONTRACTOR SHALL GUARANTEE ALL MATERIALS AND WORKMANSHIP FREE FROM DEFECTS FOR A PERIOD OF NOT LESS THAN ONE YEAR FROM DATE OF ACCEPTANCE.
10. CORRECTION OF ANY DEFECTS SHALL BE COMPLETED WITHOUT ADDITIONAL CHARGE AND SHALL INCLUDE REPLACEMENT OR REPAIR OF ANY OTHER PHASE OF THE INSTALLATION WHICH MAY HAVE BEEN DAMAGED.
11. THE ELECTRICAL INSTALLATION SHALL MEET ALL STANDARD REQUIREMENTS OF FPL.
12. CONTRACTOR SHALL BE RESPONSIBLE FOR ALL CUTTING AND PATCHING REQUIRED OF HIS WORK.
13. ELECTRICAL CONTRACTOR SHALL LABEL ALL PANELS W/ TYPE WRITTEN DIRECTORIES.
14. ALL ELECTRICAL WIRING SHALL BE THE RESPONSIBILITY OF THE ELECTRICAL CONTRACTOR.
15. DO NOT SCALE THE ELECTRICAL DRAWINGS. REFER TO THE MECHANICAL DRAWINGS & THE APPROVED MANUFACTURER'S SHOP DRAWINGS FOR THE EXACT LOCATION OF ALL EQUIPMENT.
16. *SLANTED AND SHADED TEXT* DENOTES EXISTING EQUIPMENT OR STRUCTURES. *NON-SLANTED TEXT* DENOTES NEW EQUIPMENT, STRUCTURES & WORK.
17. ALL CONTROL PANELS SHALL BE UL LISTED AND MEET THE REQUIREMENTS OF ARTICLE 409 OF THE NATIONAL ELECTRICAL CODE.

No.	REVISIONS	DATE	BY

600 NORTH PINE ISLAND ROAD, SUITE 450, PLANTATION, FL 33324  
 PHONE: 954-535-5100 FAX: 954-739-2247  
 WWW.KIMLEY-HORN.COM CA 0000696

**KHA PROJECT**  
 043138041  
**DATE**  
 MARCH 2022  
**SCALE** AS SHOWN  
 DESIGNED BY SEB  
 DRAWN BY SJL  
 CHECKED BY SEB

**NORTH BAY VILLAGE MAIN PUMP STATION IMPROVEMENTS**  
 PREPARED FOR  
**NORTH BAY VILLAGE**  
 NORTH BAY VILLAGE

LICENSED PROFESSIONAL  
 STEPHEN E. BAILEY, P.E.  
 FLORIDA LICENSE NUMBER  
 42461  
 DATE: 3/9/22

**ELECTRICAL SITE PLAN, NOTES, SYMBOLS & ABBREVIATIONS**

SHEET NUMBER  
**E-01**

10620 GRIFFIN ROAD, SUITE 202  
 COOPER CITY, FLORIDA 33328  
 PHONE: (954) 448-7930  
 C.O.A. NO. 6783  
 Stephen E. Bailey, P.E.  
 Florida P.E. No. 42461

This document, together with the concepts and designs presented herein, is intended only for the specific purpose and client for which it was prepared. Reuse of and improper reliance on this document without written authorization and adaptation by Kimley-Horn and Associates, Inc. shall be without liability to Kimley-Horn and Associates, Inc.

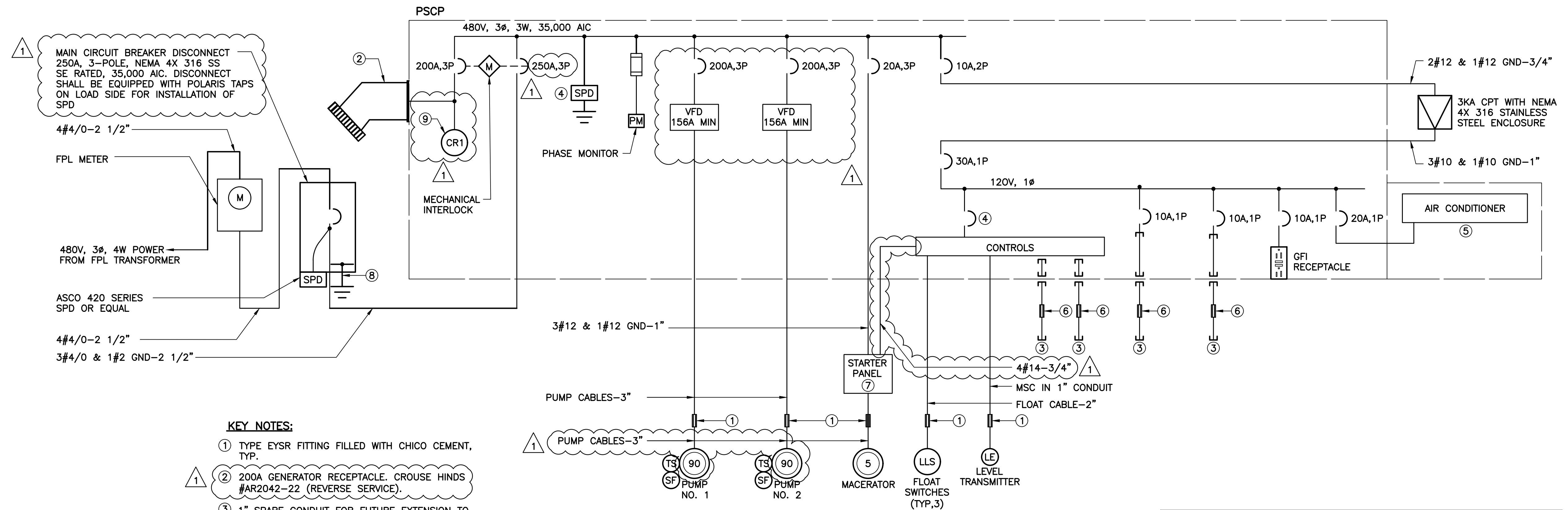

**KEY NOTES:**

- ① TYPE EYSR FITTING FILLED WITH CHICO CEMENT, TYP.
- ② 200A GENERATOR RECEPTACLE. CROUSE HINDS #AR2042-22 (REVERSE SERVICE).
- ③ 1" SPARE CONDUIT FOR FUTURE EXTENSION TO VALVE BOX AND WETWELL.
- ④ ASCO 430 SERIES.
- ⑤ CONTROL PANEL CABINET SHALL BE AIR CONDITIONED. AIR CONDITIONER SHALL BE SIZED TO MAINTAIN PANEL TEMPERATURE AT 78°F WITH 1 PUMP OPERATING & 95°F AMBIENT. MINIMUM SIZE SHALL BE 12000 BTU.
- ⑥ EMPTY EYSR FITTING.
- ⑦ MACERATOR STARTER PANEL FURNISHED UNDER DIVISION 11.
- ⑧ #2 BARE COPPER TO GROUND GRID.
- ⑨ DIVERSIFIED ELECTRONICS 480V RELAY.

**SINGLE LINE DIAGRAM**

LOAD TABULATION		
SERVICE VOLTAGE: 480V, 3Ø		
DESCRIPTION	LOAD	AMPACITY
① SUBMERSIBLE PUMPS	2 @ 90 HP EACH	= 224.00 AMPS
MACERATOR	1 @ 5 HP	= 7.80 AMPS
MISCELLANEOUS	3 KVA	= 3.60 AMPS
	CONNECTED LOAD	= 235.20 AMPS
② MINIMUM SERVICE ENTRANCE	= 235.20 AMPS + (0.25)(112.00) = 263.32 AMPS	

**NOTES:**

- ① AMPACITIES PER PUMP MFR. DATASHEETS.
- ② SERVICE ENTRANCE MINIMUM SIZE AS PER ARTICLE 230 OF THE NATIONAL ELECTRICAL CODE

No.	REVISIONS	DATE	BY
△	ADDENDUM NO. 6	03/09/22	SEB

**Kimley»Horn**

600 NORTH PINE ISLAND ROAD, SUITE 450, PLANTATION, FL 33324  
 PHONE: 954-535-5100 FAX: 954-739-2247  
 WWW.KIMLEY-HORN.COM CA 0000696

KHA PROJECT	043138041
DATE	MARCH 2022
SCALE	AS SHOWN
DESIGNED BY	SEB
DRAWN BY	SJL
CHECKED BY	SEB

**NORTH BAY VILLAGE MAIN PUMP STATION IMPROVEMENTS**

PREPARED FOR  
**NORTH BAY VILLAGE**

NORTH BAY VILLAGE FLORIDA

LICENSED PROFESSIONAL	STEPHEN E. BAILEY, P.E.
FLORIDA LICENSE NUMBER	42461
DATE:	3/9/22

**SINGLE LINE DIAGRAM**

SHEET NUMBER	E-02
--------------	------

10620 GRIFFIN ROAD, SUITE 202  
 COOPER CITY, FLORIDA 33326  
 PHONE: (954) 448-7930  
 C.O.A. NO. 6783  
 Stephen E. Bailey, P.E.  
 Florida P.E. No. 42461

**ENGINEERED CONSULTING**

**811** KNOW WHAT'S BELOW ALWAYS CALL 811 BEFORE YOU DIG  
 It's fast. It's free. It's the law.  
 www.callsunshine.com

This document, together with the concept and design presented herein, as an instrument of service, is intended only for the specific purpose and client for which it was prepared. Reuse of and improper reliance on this document without written authorization and adaptation by Kimley-Horn and Associates, Inc. shall be without liability to Kimley-Horn and Associates, Inc.

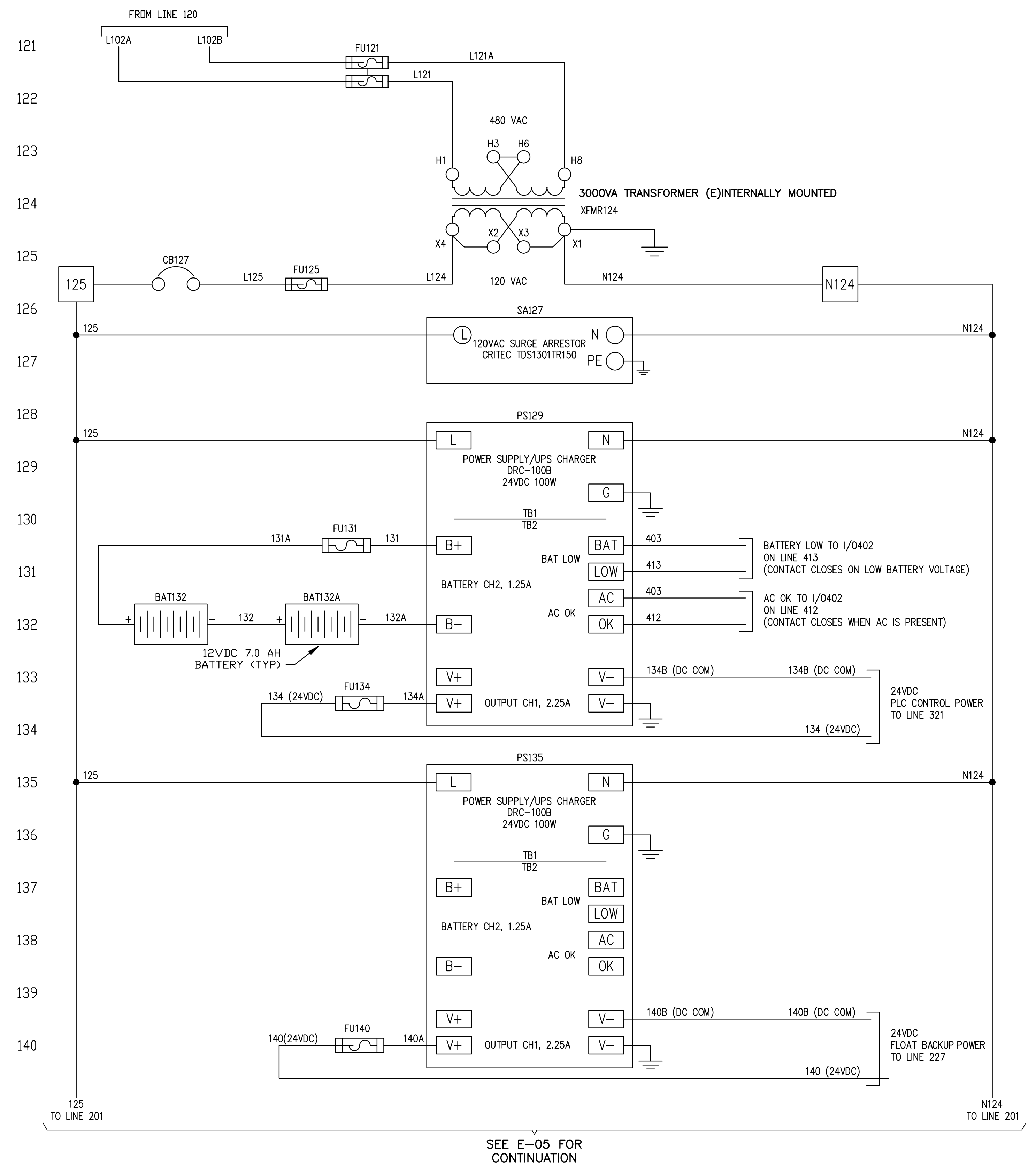
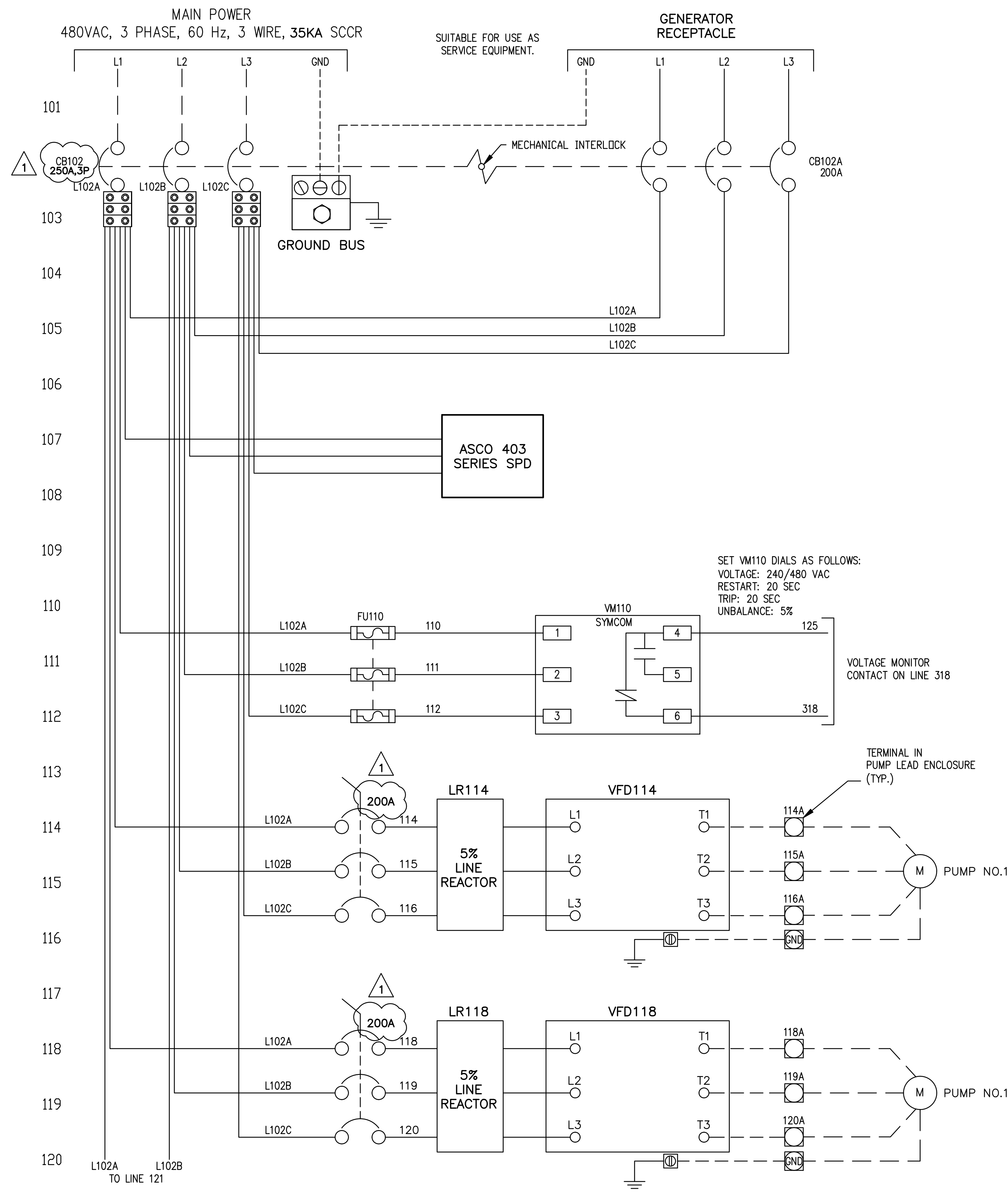

SEE E-05 FOR CONTINUATION

No.	REVISIONS	DATE	BY
1	ADDENDUM NO. 6	03/09/22	SEB

**Kimley»Horn**

600 NORTH PINE ISLAND ROAD, SUITE 450, PLANTATION, FL 33324  
 PHONE: 954-535-5100 FAX: 954-739-2247  
 WWW.KIMLEY-HORN.COM CA 0000696

KHA PROJECT 043138041
DATE MARCH 2022
SCALE AS SHOWN
DESIGNED BY SEB
DRAWN BY S.J.L.
CHECKED BY SEB

**NORTH BAY VILLAGE MAIN PUMP STATION IMPROVEMENTS**

PREPARED FOR  
NORTH BAY VILLAGE

NORTH BAY VILLAGE FLORIDA

LICENSED PROFESSIONAL STEPHEN E. BAILEY, P.E.
FLORIDA LICENSE NUMBER 42461
DATE 3/9/22

**CONTROL PANEL ELEMENTARY DIAGRAM - SHEET 1**

SHEET NUMBER <b>E-04</b>
-----------------------------

10620 GRIFFIN ROAD, SUITE 202  
 COOPER CITY, FLORIDA 33326  
 PHONE: (954) 448-7930  
 C.O.A. NO. 6783  
 Stephen E. Bailey, P.E.  
 Florida P.E. No. 42461

**ENGINEERED CONSULTANTS**

**811** KNOW WHAT'S BELOW ALWAYS CALL 811 BEFORE YOU DIG  
 It's fast. It's free. It's the law.  
 www.callsunshine.com

X:\Active Projects\Kimley-Horn\North Bay Village Pump Station Upgrades\11\_Add 6\Main PS dwgs\dwgs\E-05 CONTROL PANEL ELEMENTARY DIA-2.dwg, 3/9/2022 5:19:09 PM, abgofianu  
 This document, together with the concepts and design presented herein, as an instrument of service, is intended only for the specific purpose and client for which it was prepared. Reuse of and improper reliance on this document without written authorization and adaptation by Kimley-Horn and Associates, Inc. shall be without liability to Kimley-Horn and Associates, Inc.

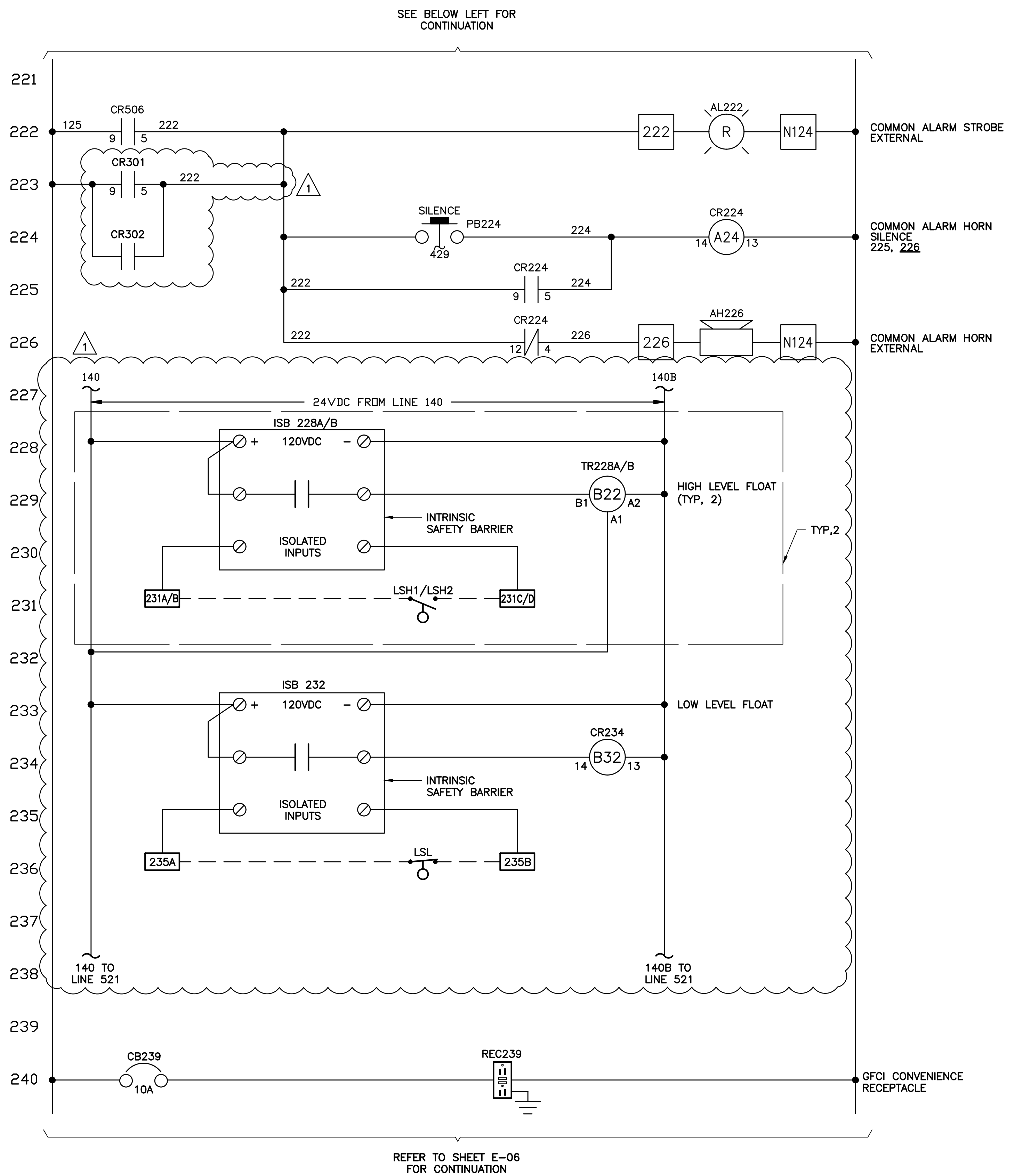
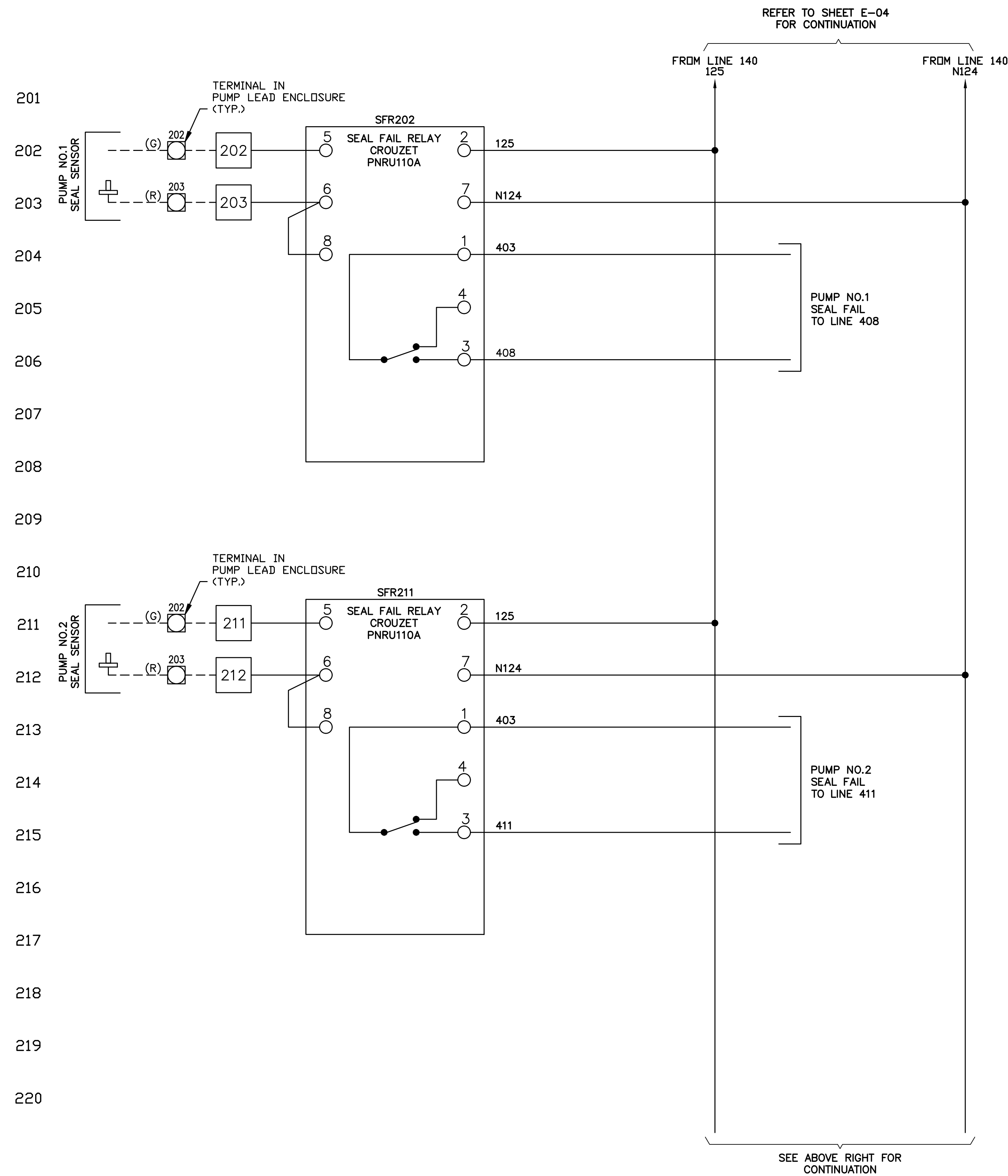

No.	REVISIONS	DATE	BY
Δ	ADDENDUM NO. 6	03/09/22	SEB

**Kimley»Horn**  
 600 NORTH PINE ISLAND ROAD, SUITE 450, PLANTATION, FL 33324  
 PHONE: 954-535-5100 FAX: 954-739-2247  
 WWW.KIMLEY-HORN.COM CA 0000696

KHA PROJECT	043138041
DATE	MARCH 2022
SCALE	AS SHOWN
DESIGNED BY	SEB
DRAWN BY	SJL
CHECKED BY	SEB

**NORTH BAY VILLAGE MAIN PUMP STATION IMPROVEMENTS**  
 PREPARED FOR  
**NORTH BAY VILLAGE**  
 NORTH BAY VILLAGE FLORIDA

LICENSED PROFESSIONAL	STEPHEN E. BAILEY, P.E.
FLORIDA LICENSE NUMBER	42461
DATE:	3/9/22

**CONTROL PANEL ELEMENTARY DIAGRAM - SHEET 2**

SHEET NUMBER	E-05
--------------	------

10620 GRIFFIN ROAD, SUITE 202  
 COOPER CITY, FLORIDA 33328  
 PHONE: (954) 448-7930  
 C.O.A. NO. 6783  
 Stephen E. Bailey, P.E.  
 Florida P.E. No. 42461

X:\Active Projects\Kimley-Horn\North Bay Village Pump Station Upgrades\E-06 CONTROL PANEL ELEMENTARY.DWG, 3/9/2022 5:15:32 PM, abgofian

This document, together with the concepts and designs presented herein, as an instrument of service, is intended only for the specific purpose and client for which it was prepared. Reuse of and improper reliance on this document without written authorization and adaptation by Kimley-Horn and Associates, Inc. shall be without liability to Kimley-Horn and Associates, Inc.

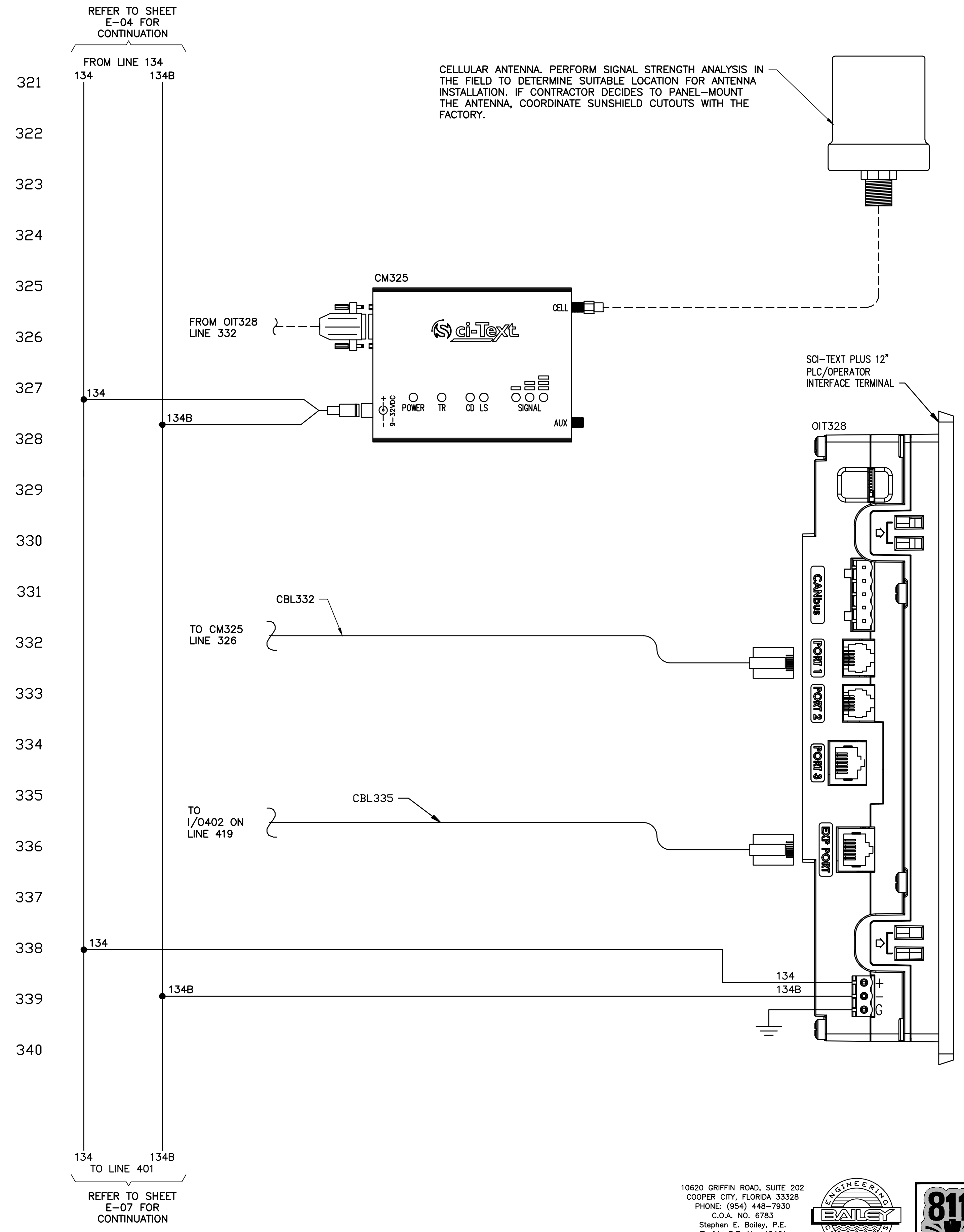
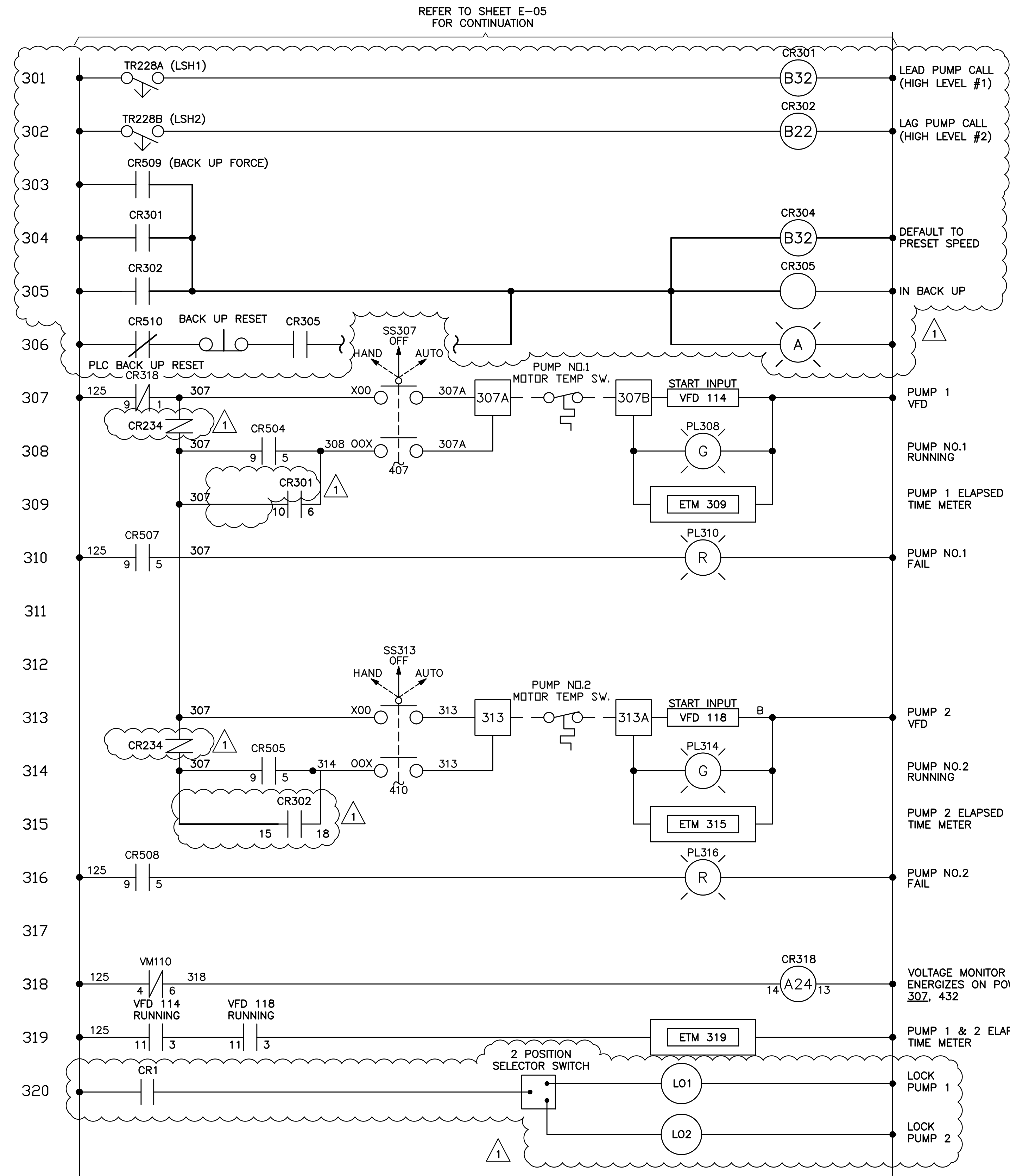

No.	REVISIONS	DATE	BY
1	ADDENDUM NO. 6	03/09/22	SEB

**Kimley»Horn**

600 NORTH PINE ISLAND ROAD, SUITE 450, PLANTATION, FL 33324  
 PHONE: 954-535-5100 FAX: 954-739-2247  
 WWW.KIMLEY-HORN.COM CA 0000696

KHA PROJECT 043138041  
 DATE MARCH 2022  
 SCALE AS SHOWN  
 DESIGNED BY SEB  
 DRAWN BY SJL  
 CHECKED BY SEB

**NORTH BAY VILLAGE MAIN PUMP STATION IMPROVEMENTS**

PREPARED FOR  
**NORTH BAY VILLAGE**

NORTH BAY VILLAGE FLORIDA

LICENSED PROFESSIONAL  
 STEPHEN E. BAILEY, P.E.  
 FLORIDA LICENSE NUMBER 42461  
 DATE: 3/9/22

**CONTROL PANEL ELEMENTARY DIAGRAM - SHEET 3**

10620 GRIFFIN ROAD, SUITE 202  
 COOPER CITY, FLORIDA 33326  
 PHONE: (954) 448-7930  
 C.O.A. NO. 6783  
 Stephen E. Bailey, P.E.  
 Florida P.E. No. 42461

**ENGINEERED BY**  
**BAILEY**  
 CONSULTANTS

**811** KNOW WHAT'S BELOW ALWAYS CALL 811 BEFORE YOU DIG  
 It's fast. It's free. It's the law.  
 www.callsunshine.com

SHEET NUMBER  
**E-06**

X:\Active Projects\Kimley-Horn\North Bay Village Pump Station Upgrades\11\_Add 6\Main PS Dwg\dwg\E-07 CONTROL PANEL ELEM DIA-4.dwg, 3/9/2022 5:15:36 PM, abgofianu

This document, together with the concepts and design presented herein, as an instrument of service, is intended only for the specific purpose and client for which it was prepared. Reuse of and improper reliance on this document without written authorization and adaptation by Kimley-Horn and Associates, Inc. shall be without liability to Kimley-Horn and Associates, Inc.

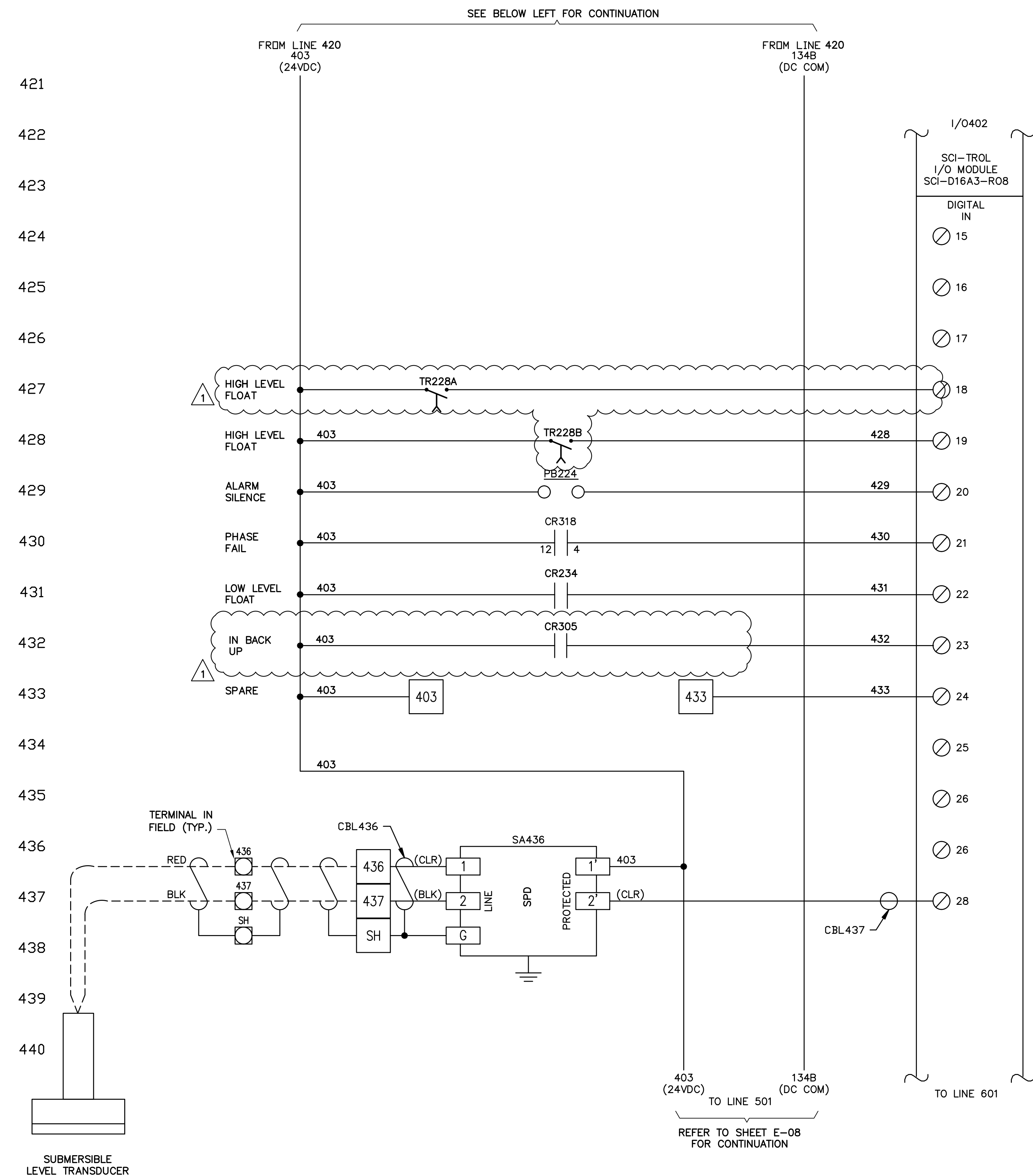
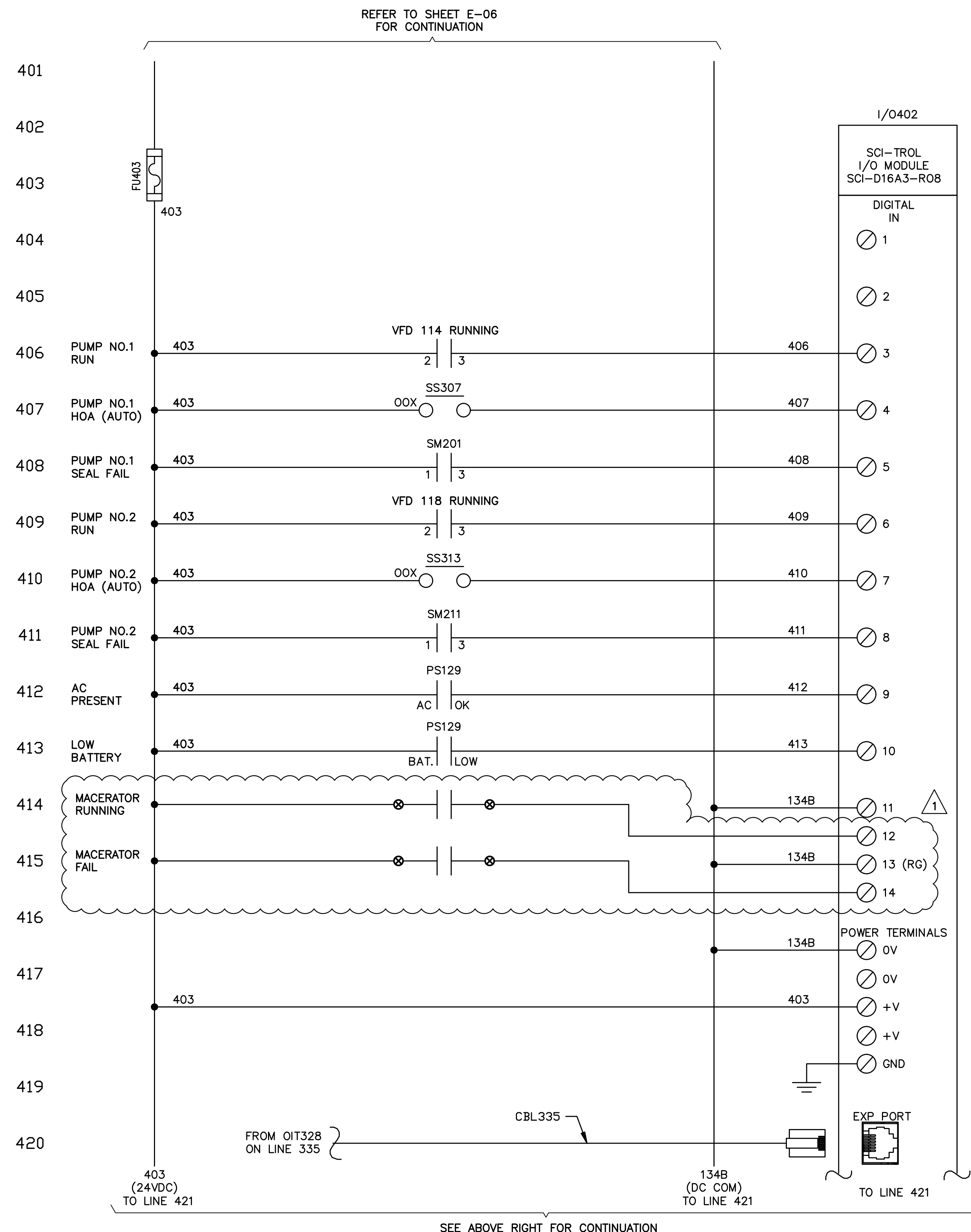

No.	REVISIONS	DATE	BY
4	ADDENDUM NO. 6	03/09/22	SEB

**Kimley»Horn**

600 NORTH PINE ISLAND ROAD, SUITE 450, PLANTATION, FL 33324  
 PHONE: 954-535-5100 FAX: 954-739-2247  
 WWW.KIMLEY-HORN.COM CA 0000696

KHA PROJECT 043138041  
 DATE MARCH 2022  
 SCALE AS SHOWN  
 DESIGNED BY SEB  
 DRAWN BY SJL  
 CHECKED BY SEB

**NORTH BAY VILLAGE MAIN PUMP STATION IMPROVEMENTS**

PREPARED FOR  
**NORTH BAY VILLAGE**

NORTH BAY VILLAGE FLORIDA

LICENSED PROFESSIONAL  
 STEPHEN E. BAILEY, P.E.  
 FLORIDA LICENSE NUMBER 42461  
 DATE: 3/9/22

**CONTROL PANEL ELEMENTARY DIAGRAM - SHEET 4**

SHEET NUMBER  
**E-07**

10620 GRIFFIN ROAD, SUITE 202  
 COOPER CITY, FLORIDA 33326  
 PHONE: (954) 448-7939  
 C.O.A. NO. 6783  
 Stephen E. Bailey, P.E.  
 Florida P.E. No. 42461

**ENGINEERED CONSULTANTS**

**811** KNOW WHAT'S BELOW ALWAYS CALL 811 BEFORE YOU DIG  
 It's fast. It's free. It's the law.  
 www.callsunshine.com

X:\Active Projects\Kimley-Horn\North Bay Village Pump Station Upgrades\11\_Add 6\Main PS Dwg\dwg\E-08 CONTROL PANEL ELEM DIA-5.dwg, 3/9/2022 5:15:41 PM, abg@kha.com

This document, together with the concepts and designs presented herein, is intended only for the specific purpose and client for which it was prepared. Reuse of and improper reliance on this document without written authorization and adaptation by Kimley-Horn and Associates, Inc. shall be without liability to Kimley-Horn and Associates, Inc.

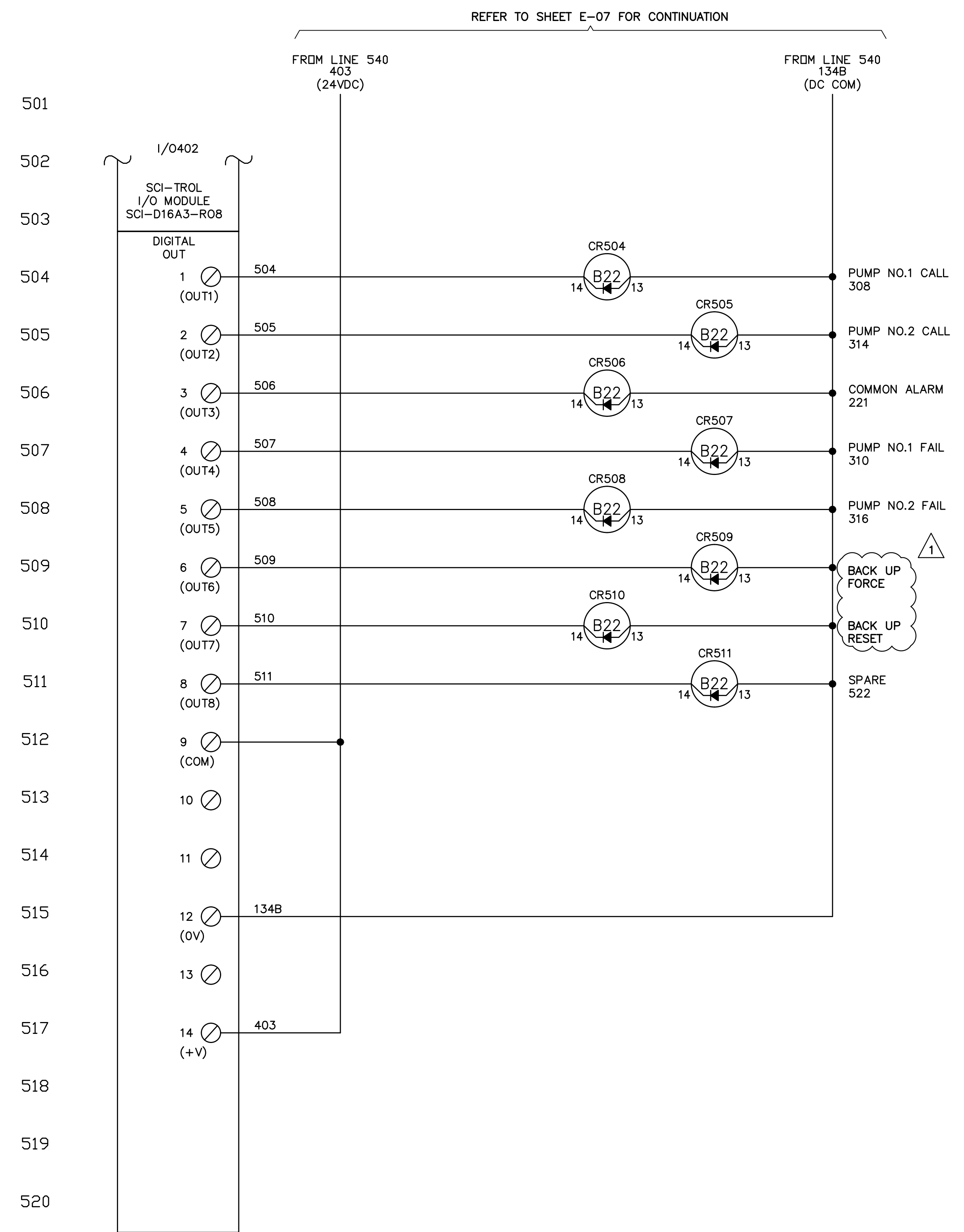
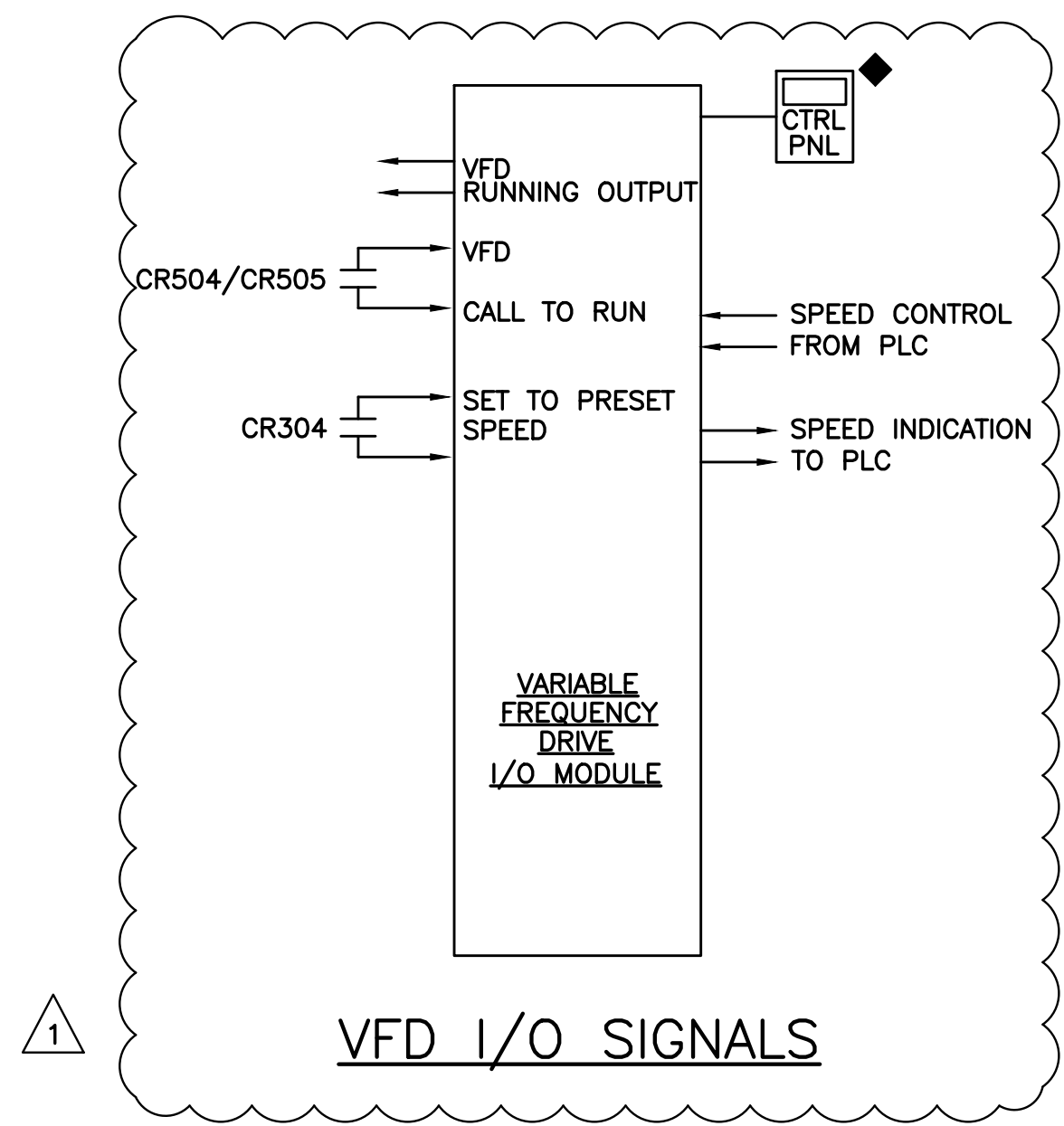

No.	REVISIONS	DATE	BY
1	ADDENDUM NO. 6	03/09/22	SEB

**Kimley-Horn**

600 NORTH PINE ISLAND ROAD, SUITE 450, PLANTATION, FL 33324  
 PHONE: 954-535-5100 FAX: 954-739-2247  
 WWW.KIMLEY-HORN.COM CA 0000696

KHA PROJECT	043138041
DATE	MARCH 2022
SCALE	AS SHOWN
DESIGNED BY	SEB
DRAWN BY	SJL
CHECKED BY	SEB

**NORTH BAY VILLAGE MAIN PUMP STATION IMPROVEMENTS**

PREPARED FOR  
**NORTH BAY VILLAGE**

NORTH BAY VILLAGE FLORIDA

LICENSED PROFESSIONAL  
 STEPHEN E. BAILEY, P.E.  
 FLORIDA LICENSE NUMBER  
 42461  
 DATE: 3/9/22

**CONTROL PANEL ELEMENTARY DIAGRAM - SHEET 5**

SHEET NUMBER  
**E-08**

10620 GRIFFIN ROAD, SUITE 202  
 COOPER CITY, FLORIDA 33326  
 PHONE: (954) 448-7930  
 C.O.A. NO. 6783  
 Stephen E. Bailey, P.E.  
 Florida P.E. No. 42461

**BAILEY ENGINEERING CONSULTANTS**

**811** KNOW WHAT'S BELOW ALWAYS CALL 811 BEFORE YOU DIG  
 It's fast. It's free. It's the law.  
 www.callsunshine.com

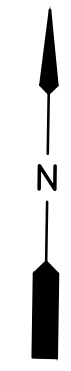
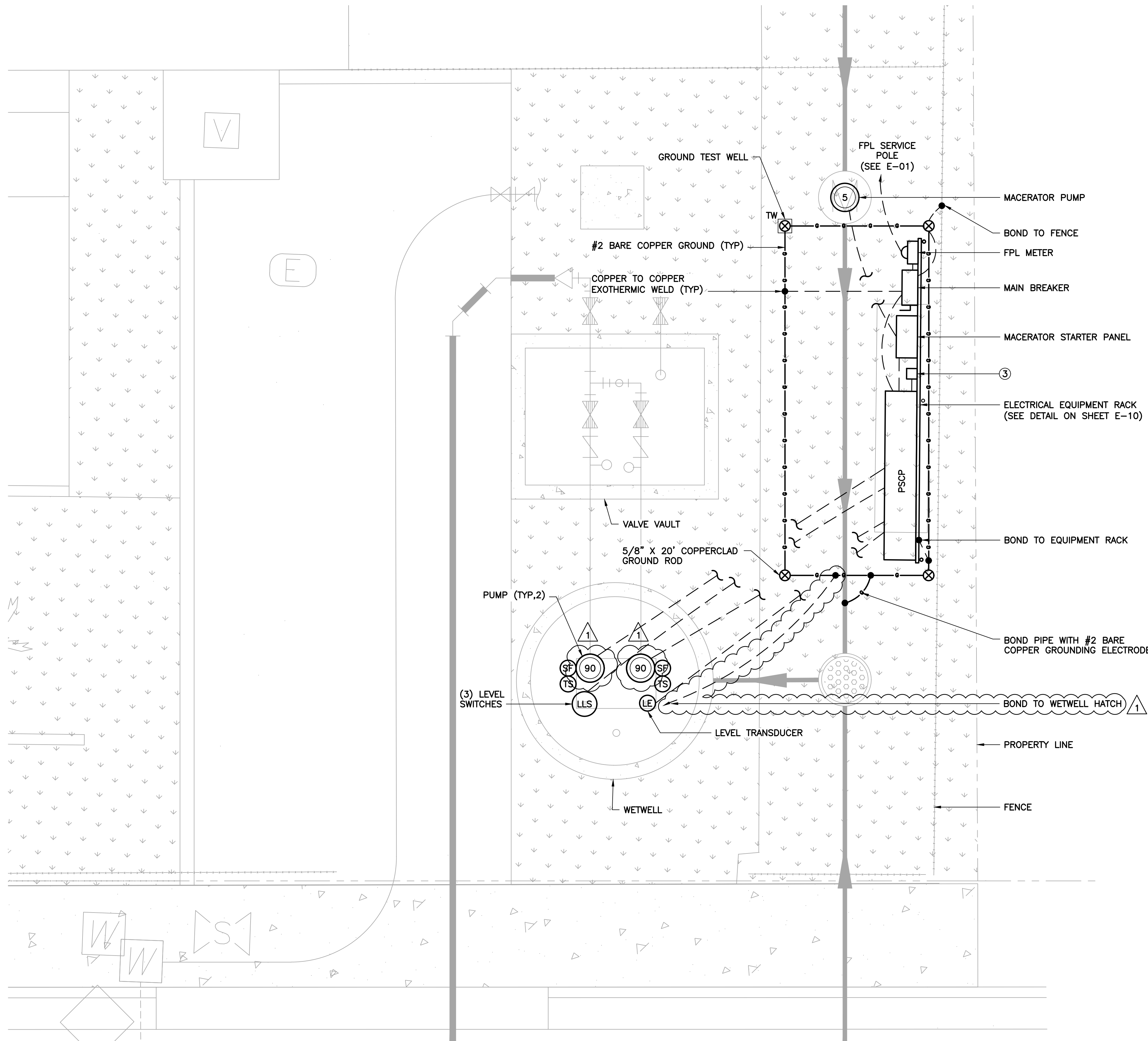

- NOTES:**
- ① REFER TO DETAILS FOR HAZARDOUS CLASSIFICATIONS. USE APPROPRIATE MATERIALS AND WIRING METHODS.
  - ② BONDING CONNECTIONS BETWEEN ELECTRODE, REBAR AND PIPING SHALL BE EXOTHERMIC.
  - ③ CPT.

**PUMP STATION ELECTRICAL PLAN VIEW**

SCALE: 3/8"=1'-0"  
 12" 0 1 2 4'

This document, together with the concepts and design presented herein, as an instrument of service, is intended only for the specific purpose and client for which it was prepared. Reuse of and improper reliance on this document without written authorization and adaptation by Kimley-Horn and Associates, Inc. shall be without liability to Kimley-Horn and Associates, Inc.

No.	REVISIONS	DATE	BY
Δ	ADDENDUM NO. 6	03/09/22	SEB



600 NORTH PINE ISLAND ROAD, SUITE 450, PLANTATION, FL 33324  
 PHONE: 954-535-5100 FAX: 954-739-2247  
 WWW.KIMLEY-HORN.COM CA 0000696

KHA PROJECT	043138041
DATE	MARCH 2022
SCALE	AS SHOWN
DESIGNED BY	SEB
DRAWN BY	SJL
CHECKED BY	SEB

**NORTH BAY VILLAGE MAIN PUMP STATION IMPROVEMENTS**  
 PREPARED FOR  
**NORTH BAY VILLAGE**  
 NORTH BAY VILLAGE FLORIDA

LICENSED PROFESSIONAL	STEPHEN E. BAILEY, P.E.
FLORIDA LICENSE NUMBER	42461
DATE:	3/9/22

**LIFT STATION ELECTRICAL PLAN VIEW**

10620 GRIFFIN ROAD, SUITE 202  
 COOPER CITY, FLORIDA 33326  
 PHONE: (954) 448-7930  
 C.O.A. NO. 6783  
 Stephen E. Bailey, P.E.  
 Florida P.E. No. 42461



SHEET NUMBER

**E-09**